



# *Imperial*

---

# *Granite & Cabinets*



[www.Imperial-Granite.com](http://www.Imperial-Granite.com)





## Table Of Content

About Us .....	Pg. 1
Granite Selection .....	Pg. 2-3
Cabinet Options & Accessories .....	Pg. 4-5
BURGUNDY (Cabinet) .....	Pg. 6
CAFE (Cabinet).....	Pg. 7
ESPRESSO (Cabinet).....	Pg. 8
MOCHA (Cabinet).....	Pg. 9
OAK (Cabinet).....	Pg. 10
PURE WHITE (Cabinet).....	Pg. 11
SPICE (Cabinet).....	Pg. 12
TOFFEE (Cabinet) .....	Pg. 13
VANILLA SHAKER (Cabinet) .....	Pg. 14
Vanity .....	Pg. 15
Various Cabinet Styles .....	Pg. 16-17
Sinks & More .....	Pg. 18-19
Measurement Guide .....	Pg. 20-21

# About Us



Imperial Granite & Cabinets, Inc. is a leading provider of pre-fabricated granite & solid wood cabinets located in Houston, Texas. Got a commercial project with a strict deadline? Or maybe a last minute residential remodel right before the holidays, with over 60,000 square feet of warehouse space and plentiful stock, Imperial Granite & Cabinets can make it happen for you. In addition to wholesale distribution, our company also offers installation services. So come by our showroom and see why so many have already chosen Imperial Granite & Cabinets for their cabinet and countertop needs.



# Granite Selection • Pre-Fabricated

Origins of the stones: Brazil, Norway, India, China, and etc. • Thickness: ¾" material with 1½" bullnose.

\*Granite selection may change over time.  
See store for details.



Baltic Brown



Black Galaxy



Blue Pearl



Blanco Portiguar

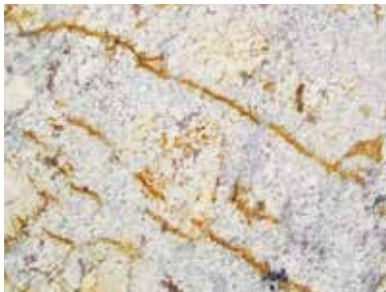

Diamond Giallo



Emerald Pearl



Galaxy White



Giallo Ornamentale

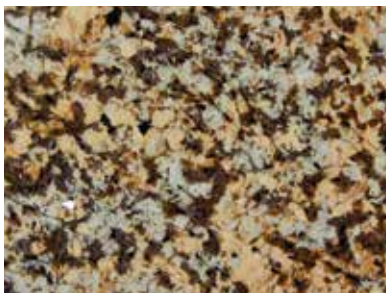

Golden Persa



Millennium Gold



Kema Giallo

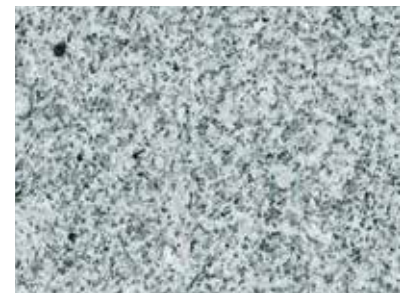

Luna Pearl





New Venetian Gold



Santa Cecilia Classic

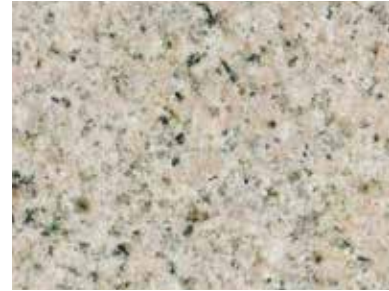

Sandy Gold



Santa Cecilia Gold



Tan Brown



Tea Brown



Tropical Brown



Uba Tuba



# Cabinet Options & Accessories

Wall End Shelf



False Door Panel



Base End Angle



Fluted Filler



Window Valance



Large Flat Molding



Crown Molding with Rope



Decorative Corbel





Wall Microwave Cabinet



Wall Diagonal Corner Cabinet



Wine Rack



Traditional Lighting Rail



Base End Shelf



Wastebasket Cabinet

Appliance Garage



Small Flat Molding



# Burgundy



Upper cabinet available in 30" & 42" standard height.

**INTERIOR:**  
1/2" Veneer Plywood Provides Wipe Clean Finish

**FACE FRAME:**  
3/4" Solid Birch Mitered Joint

**END PANELS:**  
1/2" Plywood With Matching Interior And Exterior Veneer

**BACK:**  
1/2" Plywood With Birch Captured By End Panels

**SHELVES:**  
5/8" Wood Veneer Plywood With Matching Wood Veneer Edge Banding

**SHELF SUPPORTS:**  
Metal Shelf Holder For Greater Shelf Stability And Easy Shelf Adjustment

**HINGES:**  
Nickel Plated Fully Concealed 100 Degree Opening Feature Multiple Adjustment For Ease Of Alignment

**RUNNERS:**  
Full Extension Drawers Have Stainless Steel Ball Bearings Side Mount With Greater Load Capacity And Smoother Closing Operation





# Cafe



**INTERIOR:**  
1/2" Veneer Plywood Provides Wipe Clean Finish

**FACE FRAME:**  
3/4" Solid Birch Doweled Joint

**END PANELS:**  
1/2" Plywood With Matching Interior And Exterior Veneer

**BACK:**  
1/2" Plywood With Birch Captured By End Panels

**SHELVES:**  
5/8" Wood Veneer Plywood With Matching Wood Veneer Edge Banding

**SHELF SUPPORTS:**  
Metal Shelf Holder For Greater Shelf Stability And Easy Shelf Adjustment

**HINGES:**  
Nickel Plated Fully Concealed 100 Degree Opening Feature Multiple Adjustment For Ease Of Alignment

**RUNNERS:**  
Full Extension Drawers Have Stainless Steel Ball Bearings Side Mount With Greater Load Capacity And Smoother Closing Operation



Upper cabinet available in 30", 36" & 42" standard height.

# Espresso



Upper cabinet available in 30", 36" & 42" standard height.

#### INTERIOR:

1/2" Veneer Plywood Provides Wipe Clean Finish

#### FACE FRAME:

3/4" Solid Birch Doweled Joint

#### END PANELS:

1/2" Plywood With Matching Interior And Exterior Veneer

#### BACK:

1/2" Plywood With Birch Captured By End Panels

#### SHELVES:

5/8" Wood Veneer Plywood With Matching Wood Veneer Edge Banding

#### SHELF SUPPORTS:

Metal Shelf Holder For Greater Shelf Stability And Easy Shelf Adjustment

#### HINGES:

Nickel Plated Fully Concealed 100 Degree Opening Feature Multiple Adjustment For Ease Of Alignment

#### RUNNERS:

Full Extension Drawers Have Stainless Steel Ball Bearings Side Mount With Greater Load Capacity And Smoother Closing Operation





# Mocha

Upper cabinet available in  
30", 36" & 42" standard height.

**INTERIOR:**  
1/2" Veneer Plywood Provides Wipe Clean Finish

**FACE FRAME:**  
3/4" Solid Maple Doweled Joint

**END PANELS:**  
1/2" Plywood With Matching Interior And  
Exterior Veneer

**BACK:**  
1/2" Plywood With Maple Captured By End Panels

**SHELVES:**  
5/8" Wood Veneer Plywood With  
Matching Wood Veneer Edge Banding

**SHELF SUPPORTS:**  
Metal Shelf Holder For Greater Shelf Stability  
And Easy Shelf Adjustment

**HINGES:**  
Soft Close Nickel Plated Fully Concealed  
100 Degree Opening Feature Multiple Adjustment  
For Ease Of Alignment

**RUNNERS:**  
Full Extension Soft Close Under-mount Glide



# Oak



## INTERIOR:

1/2" Veneer Plywood Provides Wipe Clean Finish

## FACE FRAME:

3/4" Solid Oak Doweled Joint

## END PANELS:

1/2" Plywood With Matching Interior And Exterior Veneer

## BACK:

1/2" Plywood With Oak Captured By End Panels

## SHELVES:

5/8" Wood Veneer Plywood With Matching Wood Veneer Edge Banding

## SHELF SUPPORTS:

Plastic Shelf Support For Easy Shelf Adjustment

## HINGES:

Nickel Plated Fully Concealed 100 Degree Opening Feature Multiple Adjustment For Ease Of Alignment

## RUNNERS:

Full Extension Drawers Have Stainless Steel Ball Bearings Side Mount With Greater Load Capacity And Smoother Closing Operation



Upper cabinet available in 30" & 42" standard height.





# Pure White



**INTERIOR:**  
1/2" Veneer Plywood Provides Wipe Clean Finish

**FACE FRAME:**  
3/4" Solid Maple Doweled Joint

**END PANELS:**  
1/2" Plywood With Matching Interior And Exterior Veneer

**BACK:**  
1/2" Plywood With Maple Captured By End Panels

**SHELVES:**  
5/8" Wood Veneer Plywood With Matching Wood Veneer Edge Banding

**SHELF SUPPORTS:**  
Metal Shelf Holder For Greater Shelf Stability And Easy Shelf Adjustment

**HINGES:**  
Nickel Plated Fully Concealed 100 Degree Opening Feature Multiple Adjustment For Ease Of Alignment

**RUNNERS:**  
Full Extension Soft Close Under-mount Glide

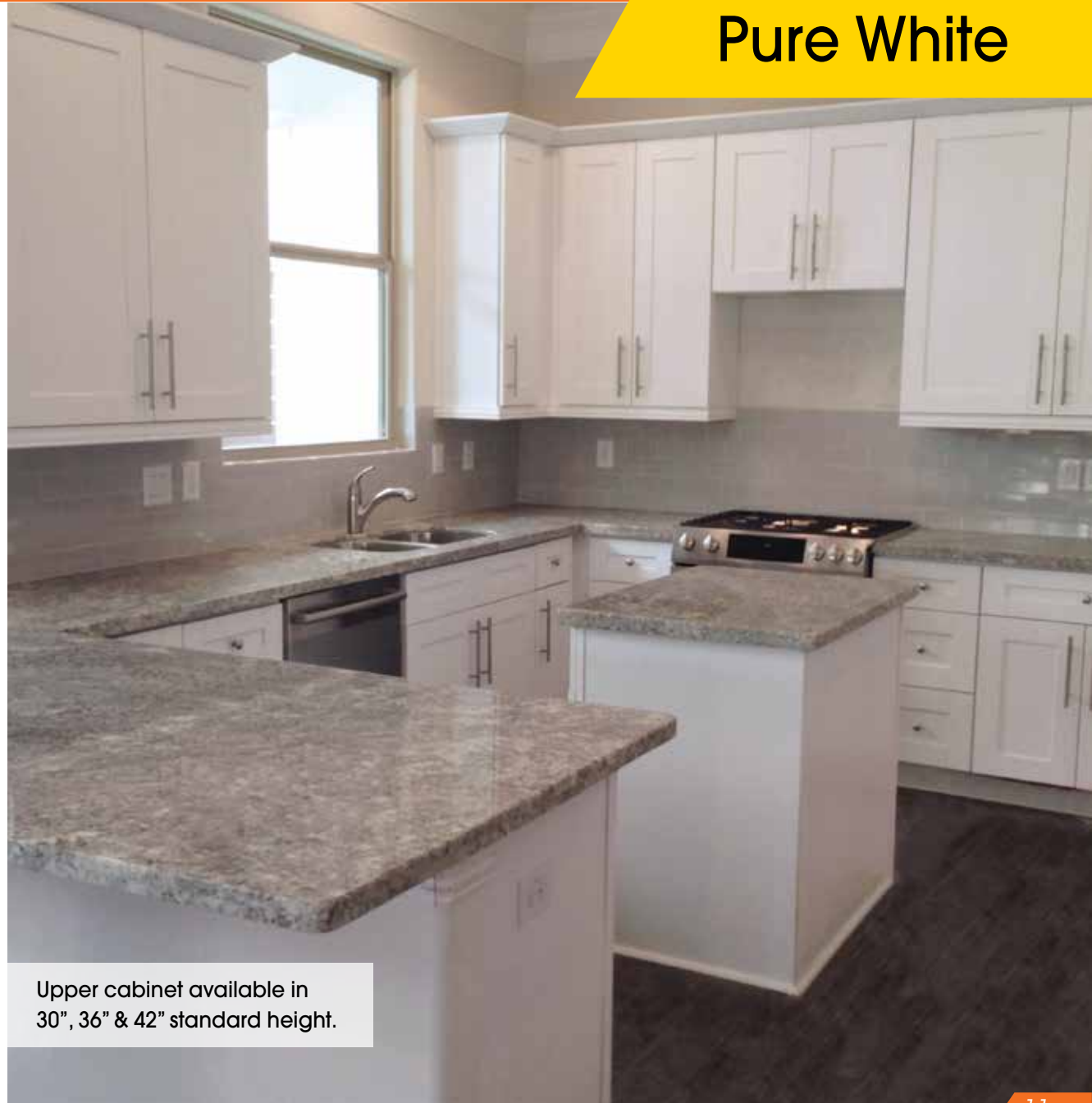

Upper cabinet available in  
30", 36" & 42" standard height.

# Spice



Upper cabinet available in 30" & 42" standard height.

## INTERIOR:

1/2" Veneer Plywood Provides Wipe Clean Finish

## FACE FRAME:

3/4" Solid Maple Doweled Joint

## END PANELS:

1/2" Plywood With Matching Interior And Exterior Veneer

## BACK:

1/2" Plywood With Maple Captured By End Panels

## SHELVES:

5/8" Wood Veneer Plywood With Matching Wood Veneer Edge Banding

## SHELF SUPPORTS:

Metal Shelf Holder For Greater Shelf Stability And Easy Shelf Adjustment

## HINGES:

Nickel Plated Fully Concealed 100 Degree Opening Feature Multiple Adjustment For Ease Of Alignment

## RUNNERS:

Full Extension Drawers Have Stainless Steel Ball Bearings Side Mount With Greater Load Capacity And Smoother Closing Operation





# Toffee



**INTERIOR:**  
1/2" Veneer Plywood Provides Wipe Clean Finish

**FACE FRAME:**  
3/4" Solid Maple Doweled Joint

**END PANELS:**  
1/2" Plywood With Matching Interior And Exterior Veneer

**BACK:**  
1/2" Plywood With Maple Captured By End Panels

**SHELVES:**  
5/8" Wood Veneer Plywood With Matching Wood Veneer Edge Banding

**SHELF SUPPORTS:**  
Metal Shelf Holder For Greater Shelf Stability And Easy Shelf Adjustment

**HINGES:**  
Nickel Plated Fully Concealed 100 Degree Opening Feature Multiple Adjustment For Ease Of Alignment

**RUNNERS:**  
Full Extension Drawers Have Stainless Steel Ball Bearings Side Mount With Greater Load Capacity And Smoother Closing Operation



Upper cabinet available in 30" & 42" standard height.

# Vanilla Shaker



Upper cabinet available in 30" & 42" standard height.

**INTERIOR:**  
1/2" Veneer Plywood Provides Wipe Clean Finish

**FACE FRAME:**  
3/4" Solid Maple Doweled Joint

**END PANELS:**  
1/2" Plywood With Matching Interior And Exterior Veneer

**BACK:**  
1/2" Plywood With Maple Captured By End Panels

**SHELVES:**  
5/8" Wood Veneer Plywood With Matching Wood Veneer Edge Banding

**SHELF SUPPORTS:**  
Metal Shelf Holder For Greater Shelf Stability And Easy Shelf Adjustment

**HINGES:**  
Soft Close Nickel Plated Fully Concealed 100 Degree Opening Feature Multiple Adjustment For Ease Of Alignment

**RUNNERS:**  
Full Extension Soft Close Under-mount Glide





# Vanity



Oak



Oak



Toffee



Espresso



Cafe



Burgundy



Spice with Linen Closet



Spice

# Our Various Cabinet Styles

Depending on style of cabinets, actual cabinet may vary. Use these pictures for reference only.

## Base Cabinets

Standard Base Cabinets are 24" Deep x 34.5" High

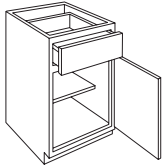

**Base Cabinet**  
1 Door, 1 Drawer  
B09, B12, B15,  
B18, B21

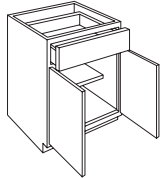

**Base Cabinet**  
2 Doors, 1 Drawer  
B24, B27, B30

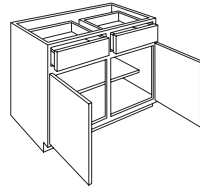

**Base Cabinet**  
2 Doors, 2 Drawers  
B33, B36, B39, B42

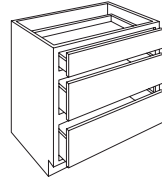

**Drawer Base**  
3 Drawers  
DB12, DB15, DB18, DB21,  
DB24, DB27, DB30, DB33,  
DB36

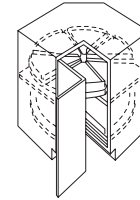

**Base Lazy Susan**  
BLS33, BLS36

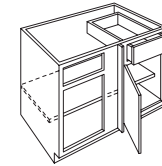

**Base Blind Corner**  
1 Door, 1 Drawer  
BBC36/42L, BBC36/42R  
BBC33/40L, BBC33/40R

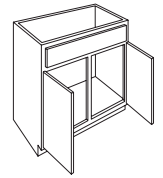

**Sink/Range Base**  
1 Panel, 2 Doors  
SB30

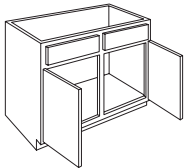

**Sink/Range Base**  
2 Panels, 2 Doors  
SB33, SB36, SB39, SB42

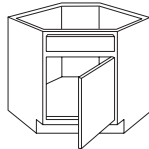

**Diagonal Corner Sink Base**  
1 Panel, 1 Door  
NCSB36

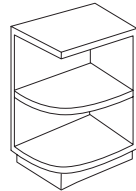

**Base End Shelf**  
BES09L, BES09R

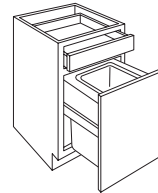

**Base Trash Cabinet**  
1 Drawer, 1 Door  
BWBK18

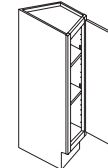

**Base Angle Cabinet**  
1 Door  
BEA12L, BEA12R

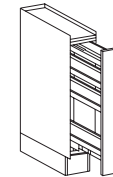

**Base Spice Rack**  
1 Door  
BSR09

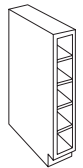

**Base Wine Cabinet**  
BWR06, BWR12

## Vanity Cabinets

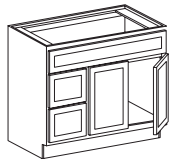

**Vanity Sink Base with Drawers**  
1 Panel, 2 Doors and 2 Drawers  
VA302134DL, VA302134DR  
VA362134DL, VA362134DR,  
VA422134DL, VA422134DR

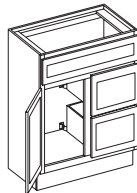

**Vanity Sink Base with Drawers**  
1 Panel, 1 or 2 Doors and 2 Drawers  
VA302134DL, VA302134DR

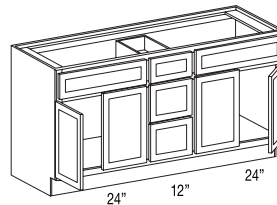

**Vanity Double Sink Base**  
2 Panel, 4 Doors and 3 Drawers  
VA602134DD

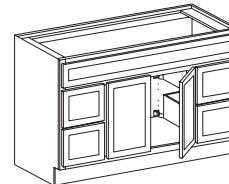

**Vanity Sink Base with Drawers**  
1 Panel, 2 Doors and 4 Drawers  
VA482134D, VA602134D

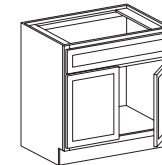

**Vanity Sink Base**  
1 Panel, 2 Doors  
VA242134, VA302134,  
VA362134



**Vanity Drawer Base**  
3 Drawers  
VDB12, VDB15,  
VDB18, VDB24



## Wall Cabinets

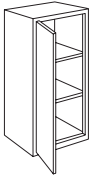

**Wall Single Door**  
Width: 9", 12", 15",  
18", 21"

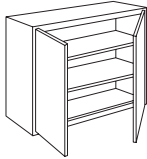

**Wall Double Doors**  
Width: 24", 27", 30",  
33", 36", 39", 42"

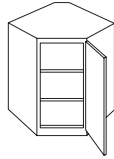

**Wall Diagonal Corner Cabinet (WDC)**  
Width: 24", 27"  
Height: 30", 36", 42"

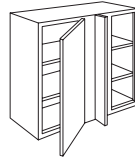

**Wall Blind Corner Cabinet (WBC)**  
Width: 27"

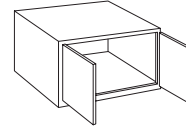

**Wall Refrigerator Cabinet**  
Width: 33", 36", 39"  
Depth: 24"  
Height: 12", 15", 18", 21", 24"

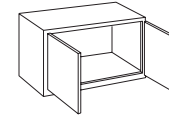

**Wall Cabinet**  
Width: 24", 27", 30", 33",  
36", 39"  
Depth: 12"  
Height: 12", 15", 18", 24", 27"

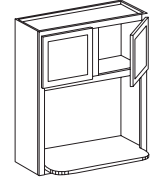

**Wall Microwave Cabinet (WM)**  
Width: 27"  
(Opening: 24" x 16")

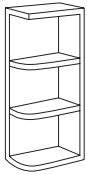

**Wall End Shelf**  
Width: 9"  
(Left or Right)

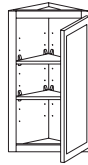

**Wall End Cabinet (WEC)**  
Width: 12"

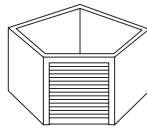

**Corner Appliance Garage**  
Width: 24"

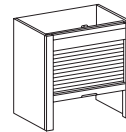

**Appliance Garage**  
Width: 18"

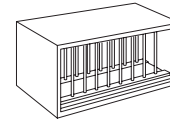

**Plate Rack**  
Width: 30", 36"  
Depth: 12"  
Height: 15"

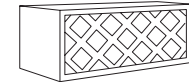

**Wine Rack**  
Width: 30", 36"  
Depth: 12"  
Height: 12", 15"

### Note:

Standard Wall Cabinet is 12" depth and heights of either 30", 36" or 42". Some cabinets heights range from 12"- 42". For details see Imperial Granite & Cabinets designers.

- 12", 15", 18" and 21" high wall cabinets doesn't include shelves.
- 24" high includes 1 adjustable shelf.
- 30" and 36" high includes 2 adjustable shelves.
- 42" high includes 3 adjustable shelves.

## Pantry and Tall Cabinet

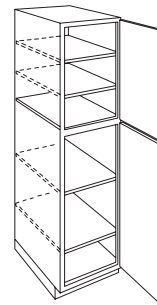

**Single Door Pantry**  
Width: 18"  
Depth: 24"  
Height: 84", 90" or 96"

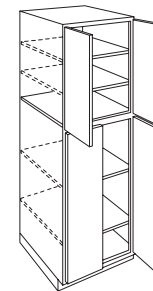

**Double Door Pantry**  
Width: 24", 30"  
Depth: 24"  
Height: 84", 90"  
or 96"

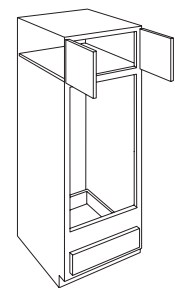

**Oven Cabinet**  
Width: 30", 33"  
Depth: 24"  
Height: 84", 90" or 96"

# Sinks & more...



SK 5747



Granite Vessel Sink



SK 8545-L



SK 8545-RT



SK-768-462





# Measurement Guide

## Step-By-Step Measuring Guidelines

Use these measuring guidelines in order to get a more accurate estimate. We recommend that one of our representatives take final measurements before ordering any cabinets.

### Step 1: Begin by measuring the room wall-to-wall.

(You will be recording all measurements in INCHES.)

Example: 108", not 9')

**Step 2:** Make a rough drawing of the shape of the room. Represent each wall, door, window and any protrusions on recessed areas. This plan does **NOT** need to be 'to scale'. Print out a grid, or do it free hand.

Only accuracy counts, not talent!

### Step 3: Measure each wall section and record on the drawing. (A wall section is from one corner to a door way or window.)

Measure each window and door and record. NOTE: windows and doors are measured from outside edge to outside edge of casing or trim.

### Step 4: Add up all dimensions on each wall and verify that the total is equal to the total wall dimension listed on the chart.

(If not, re-measure!)

### Step 5: Locate the center line of the sink, by measuring from one corner of the wall. Record this dimension on your rough drawing.

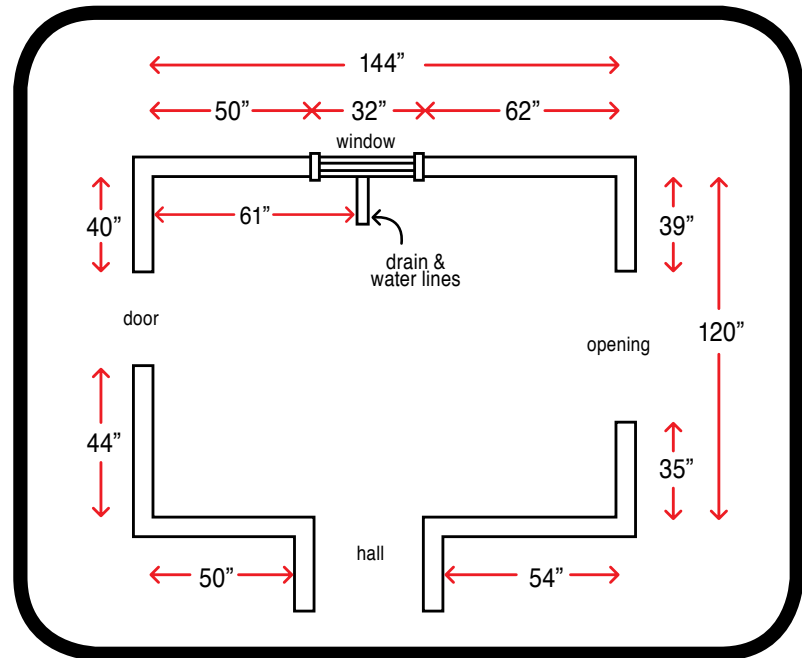



On a separate grid, take horizontal measurements of where the cabinets will be installed.  
See example below:

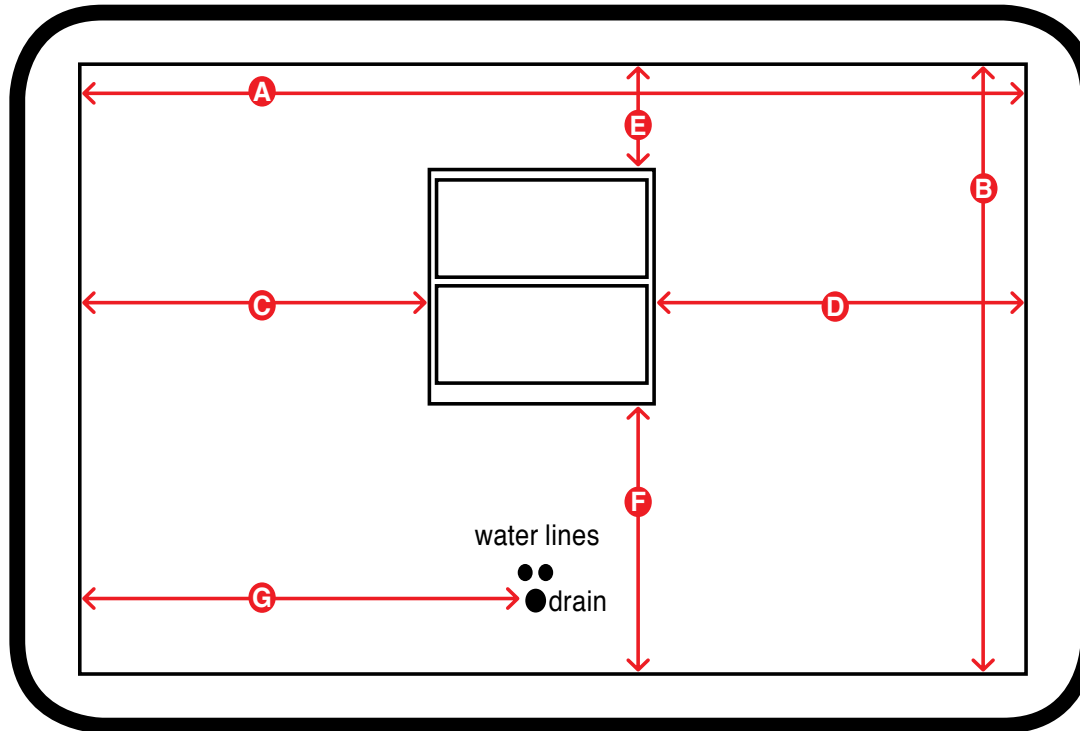

- A** Measure entire wall from left to right.
- B** Measure from ceiling to floor. (Please indicate if you have soffits)
- C** & **D** Measure horizontal wall spaces between doors, windows, wall openings, etc.
- E** & **F** Measure vertical wall spaces above & below windows, above doors.
- G** Measure from one corner of the wall to the center of sink drain and water lines.

# *Imperial*

---

■ ■ *Granite &  
Cabinets*

**Showroom Open To Public**

7265 W. 43rd Street, Houston, TX

(On 43rd Street, 1 Mile West of Highway 290)

**Tel: 713-460-6510**

Showroom Hours: Monday - Saturday 8AM - 5PM



Over 60,000 sq.ft. of Showroom & Warehouses

Visit Our Website: [www.Imperial-Granite.com](http://www.Imperial-Granite.com)